

V-FLEX SDII 10W/meter type

10W/METER TYPE

FEATURES

- + Rigid / Single-housing Linear Fixture
- + IP65 Rated (No direct exposure to Sun & Rain)
- + Narrow LED Pitch 5mm =Near-dotless effect
With optional opal capping, achieve full dotless
- + Optional Accessory of C-Shape capping (available in Opal / Semi-frost)

Opal (Light transmission 50%) Semi-frost (Light transmission 90%)



- + Available CCT 1800K 2000K 2200K 2700K 3000K 3500K 4000K 4500K
- + CRI Ra93 (typical) Ra90min



With Optional Accessory of C-Shape Capping

BASIC SPECIFICATION

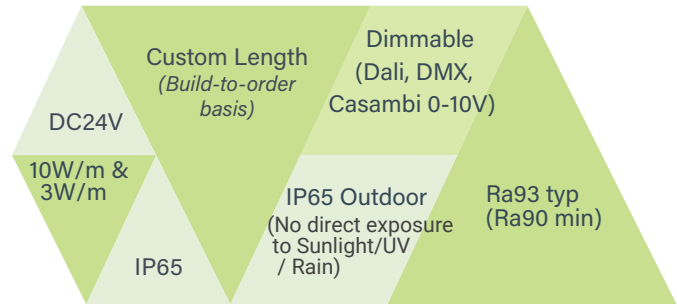

PRODUCT SPECIFICATIONS

| Product Name | V-Flex SDII 10W/meter Type | | | | |
|--|---|---------------------------------|---------------------------------|-------------------------------------|-----------------------------------|
| Model No. | VMS1200-XX3B-W-10W (L1.2m / L1135mm) | VMS1000-XX3B-W-10W (L1000mm) | VMS0855-XX3B-W-10W (L855mm) | VMS0500-XX3B-W-10W (L0.5m / L505mm) | VMS0300-XX3B-W-10W (L0.3m /295mm) |
| Input Voltage | 24Vdc | 24Vdc | 24Vdc | 24Vdc | 24Vdc |
| Power Consumption | 11.3W | 10.0W | 8.6W | 5.0W | 3.0W |
| Dimension (mm) W/O Optional Capping | 1135*19*12(H) | 1000*19*12(H) | 855*19*12(H) | 505*19*12(H) | 295*19*12(H) |
| Weight | 217 grams | 190 grams | 163 grams | 98 grams | 60 grams |
| Casing Body | Aluminium Heatsink with UV-resistant Polycarbonate Semi-Frosted Diffuser | | | | |
| LED Beam Angle | 140° | 140° | 140° | 140° | 140° |
| Operating Temperature | -10°C~50°C | -10°C~50°C | -10°C~50°C | -10°C~50°C | -10°C~50°C |
| Max. Length of Series Connection | 5 meter | 5 meter | 5 meter | 5 meter | 5 meter |
| Option Parts | Mounting clip bracket 0° (flat) type / 45° fixed angle type | | | | |
| No of LEDs | 224 | 196 | 168 | 98 | 56 |
| Power Supply Unit (Gear-Driver) | 24Vdc Contant-Voltage Switching Power Supply (TDK Lamba, Sold Separately) | | | | |
| Dimmable Control | Dimmable | Dimmable | Dimmable | Dimmable | Dimmable |
| Lumens (typical) @ 3000K without C-shape Cover) | 1129 Estimated / IES Not Ready | 995 Estimated/ IES not ready | 850 Estimated/ IES Not Ready | 497 Estimated/ IES Not ready | 298 Estimated/IES Not Ready |

Available LED Colour: 1800K 2000K 2200K 2700K 3000K 3500K 4000K 4500K & Tunable White (2000K-4000K)

OPTIONAL ACCESSORIES

1 Mounting Clip Bracket 0° Flat Type

Model: MC-0DEG

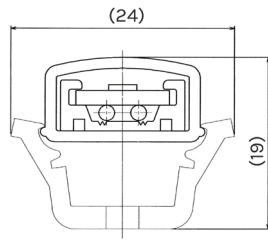
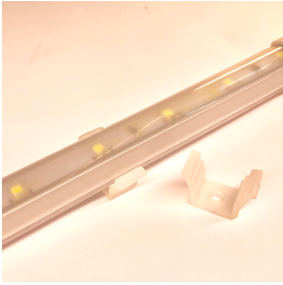

2 Mounting Clip Bracket 45° Type

Model: MC-45DEG

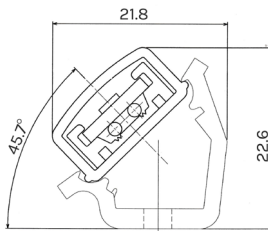

4 C-Shape Capping Cover (Opal & Semi-frost) As Optional

Opal / Light Transmission 50% Semi-frost / Light Transmission 90%

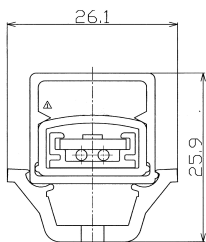
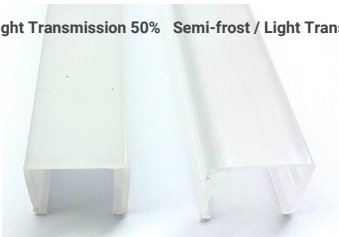

PHOTOMETRICS

BROWNIE Lab 190214

VMS1000-303B-W-10W Data WITHOUT C-Shape capping

Article No.: VMS1000-303B-W-10W

Luminous flux (Luminaire): Estimated 995 lm per meter

Luminous flux (Lamps): Estimated 995 lm per meter

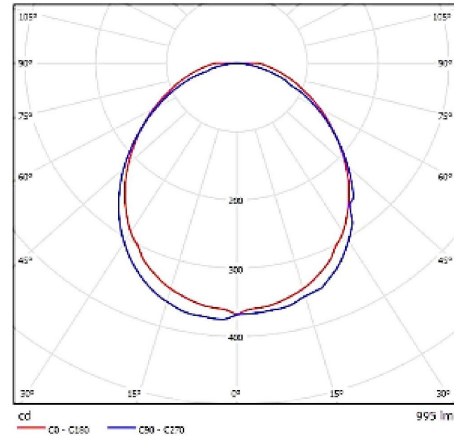

BROWNIE Lab 190215

VMS1000-303B-W-3W Data WITHOUT C-Shape capping

Article No.: VMS1000-303B-W-3W

Luminous flux (Luminaire): Estimated 312lm per meter

Luminous flux (Lamps): Estimated 312lm per meter

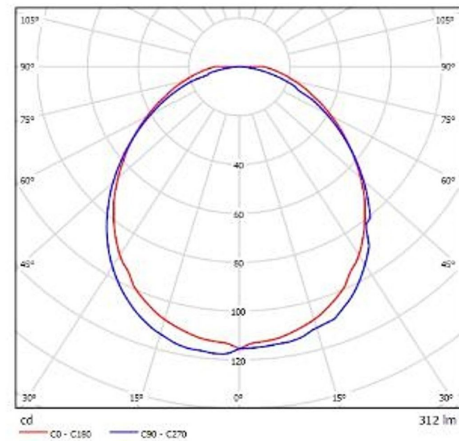

BROWNIE Lab 190223

VMS1000-303B-W-10W WITH C-Shape Capping Cover(Opal)

Article No.: VMS1000-303B-W-8W WITH C-shape Capping

Luminous flux (Luminaire): 897 lm

Opal type (Dotless)

Luminous flux (Lamps): 897 lm

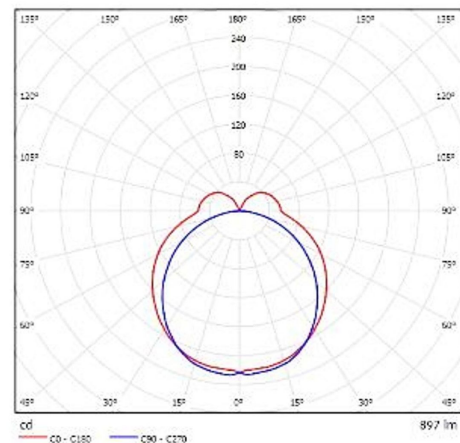

:: For IES data, please contact our sales staff or distributor